

변경 내용	
NO	
1	Mold Cap. Change
2	공차 추가

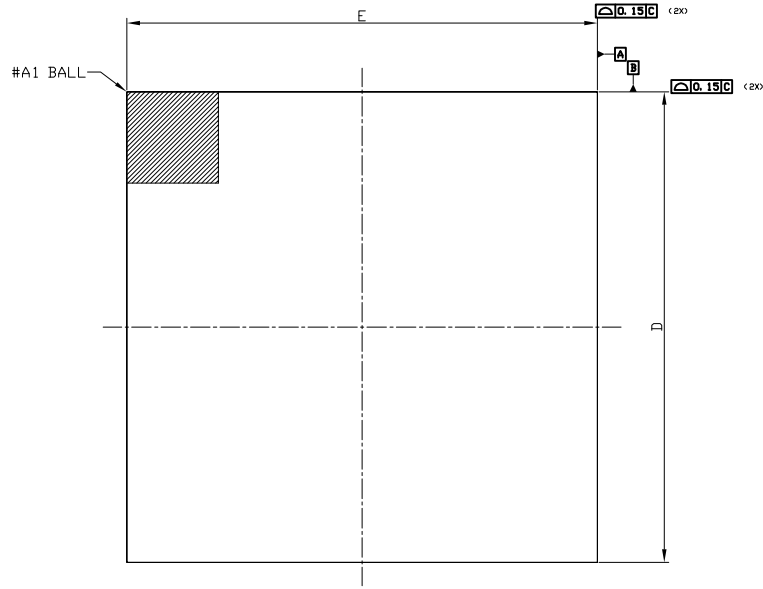

TOP VIEW

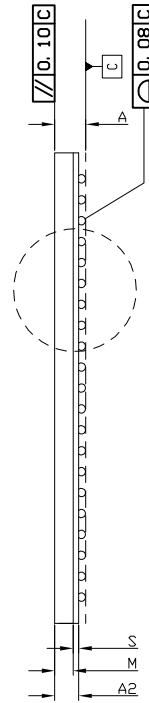

SIDE VIEW

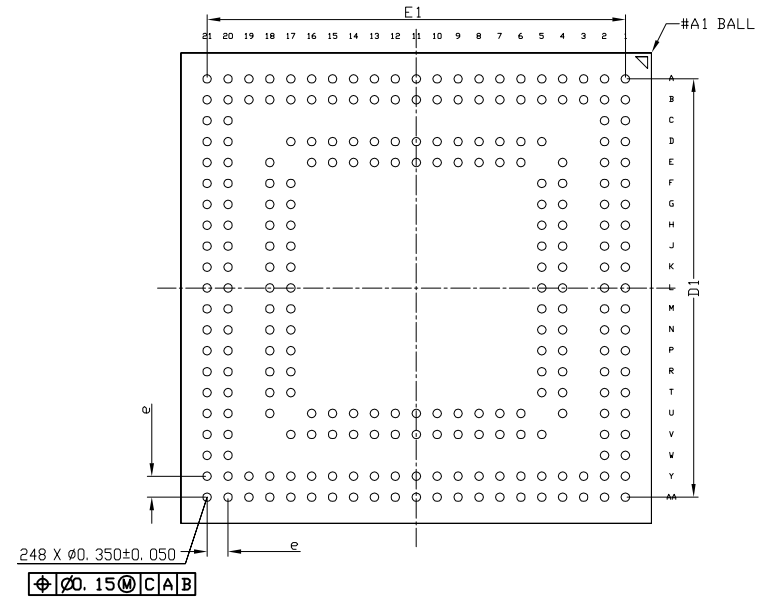

BOTTOM VIEW

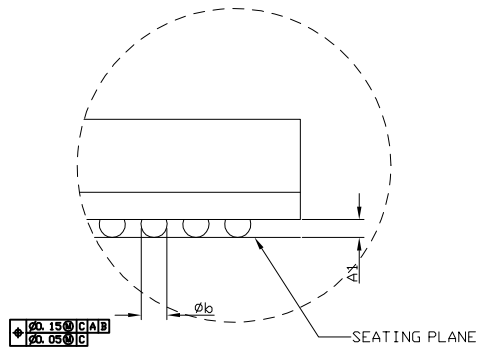

DETAIL "A"  
ROTATED 90°  
(SCALE 4/1)

DIMENSION	MINIMUM	NORMAL	MAXIMUM
D	17.90	18.00	18.10
E	17.90	18.00	18.10
D1	-	16.00	-
E1	-	16.00	-
e	-	0.80	-
A	-	1.18	1.28
A1	0.22	0.27	0.32
A2	0.86	0.91	0.96
b	0.30	0.35	0.40
M	0.68	0.70	-
S	0.17	0.21	0.25

BALL COUNT : 248

- NOTES:
1. ALL DIMENSIONS AND TOLERANCE CONFORM TO CUTOMER
  2. PIN 1 IDENTIFIER CAN BE CHAMFER, INK MARK, METALLIZED MARK OR SHINY DOT, MUST BE BUT LOCATED WITHIN ZONE INDICATED.
  3. DIMENSION "b" IS MEASURED AT THE MAXIMUM SOLDER BALL DIAMETER PARALLEL TO PRIMARY DATUM C.
  4. COMPLIANT TO JEDEC REGISTERED OUTLINE MO-XXX.
  5. RAW SOLDER BALL SIZE DURING ASSEMBLY IS Ø0.35mm.

			TITLE		248FBGA, 18.0X18.0mm, 0.35BALL, 0.80PITCH, 0.70CAP, 1.28THICKNESS			
			DES. BY TK JOEN 18.08.20		DWG. NO		GPD0208	
CHE. BY				REV. NO		UNIT	SCALE	SHEET
DRA. BY				2		mm	1:1	1/1
APP. BY								