

NO	변경 내용

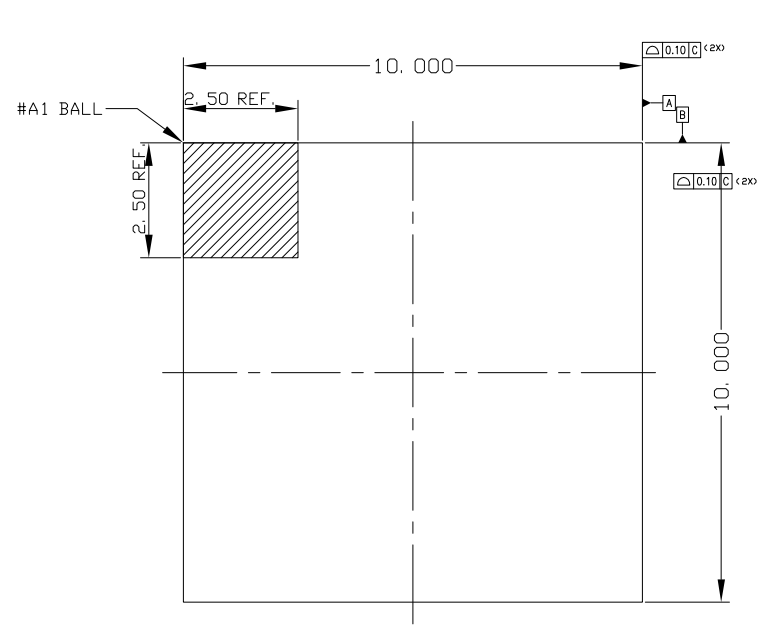

TOP VIEW

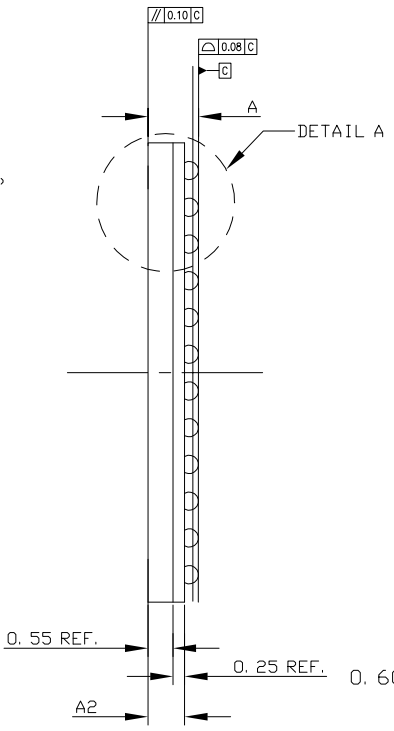

SIDE VIEW

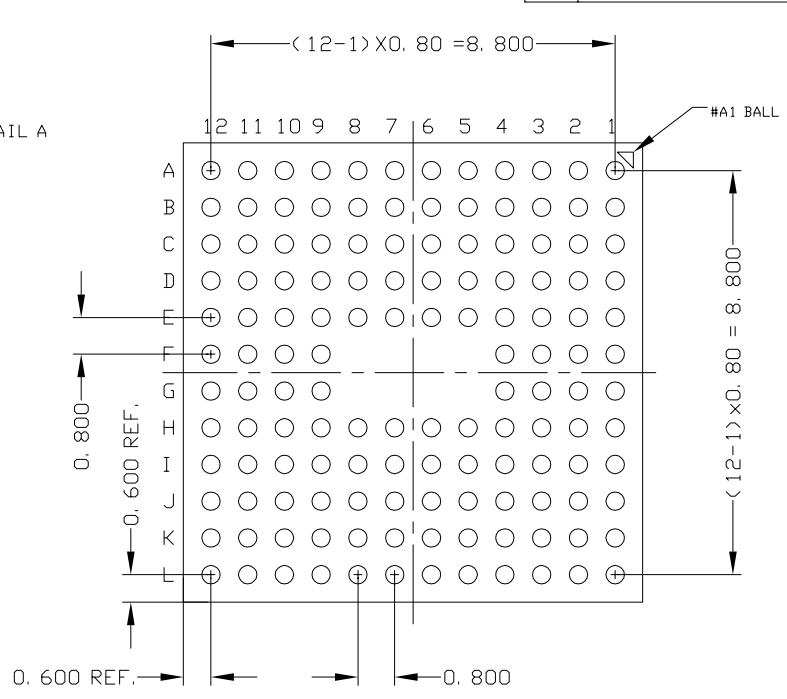

BOTTOM VIEW

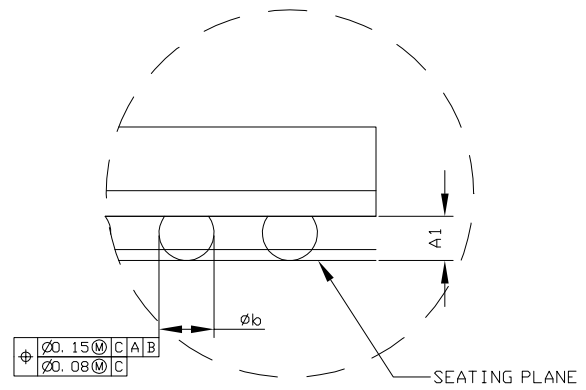

DETAIL A  
ROTATED 90°

DIMENSION	MINIMUM	NORMAL	MAXIMUM
A	-	1.10	1.20
A1	0.25	0.30	0.35
A2	0.74	0.80	0.86
b	0.35	0.40	0.45
BALL COUNT : 136			

- NOTES:
1. ALL DIMENSIONS AND TOLERANCE CONFORM TO ASME Y14.5M-1994.
  2. PIN 1 IDENTIFIER CAN BE CHAMFER, INK MARK, METALLIZED MARK OR SHINY DOT, MUST BE BUT LOCATED WITHIN ZONE INDICATED.
  3. DIMENSION "b" IS MEASURED AT THE MAXIMUM SOLDER BALL DIAMETER PARALLEL TO PRIMARY DATUM C.
  4. COMPLIANT TO JEDEC REGISTERED OUTLINE MO-XXX.
  5. RAW SOLDER BALL SIZE DURING ASSEMBLY IS φ0.40mm.

UNLESS OTHERWISE SPECIFIED  
DIMENSIONS ARE IN MIUMETERS.  
TOLERANCES ARE:

DECIMALS                      ANGLES  
X.            ± 0.1                      ± 1°  
X.XX        ± 0.05  
X.XXX      ± 0.050

			TITLE		136FBGA, 10X10mm, 136BALL, 0.80PITCH, 0.55CAP, 1.20THICKNESS						
			DES. BY		DWG. NO		GPD0098				
CHE. BY		14.03.17		REV. NO		UNIT		SCALE		SHEET	
DRA. BY				0		MM		NONE		1/1	
APP. BY		이사/이우섭		14.03.17							