

NO	변경 내용

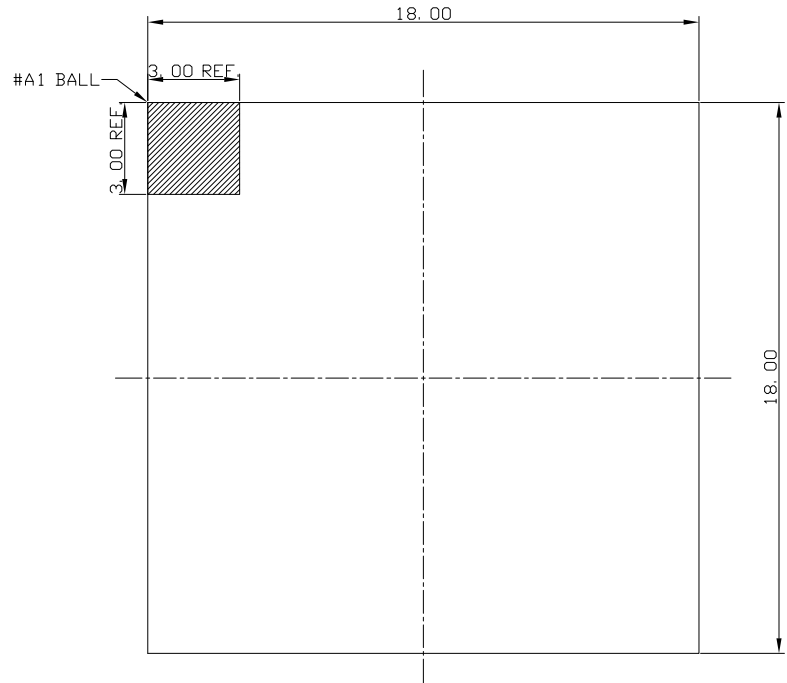

TOP VIEW

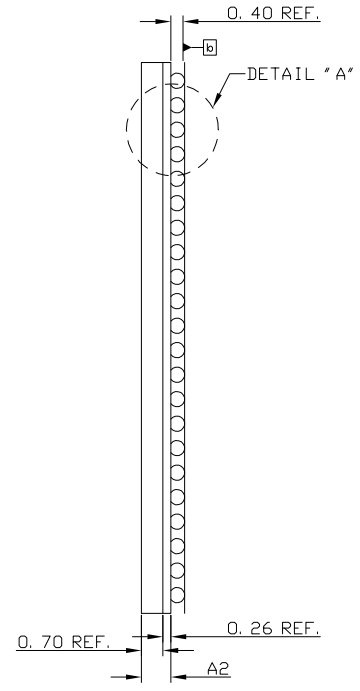

SIDE VIEW

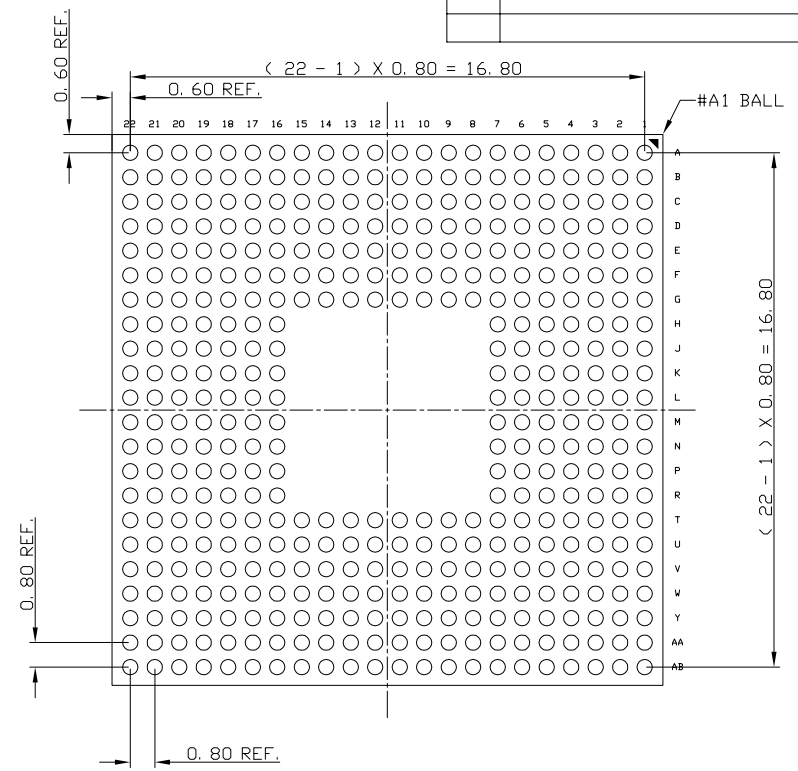

BOTTOM VIEW

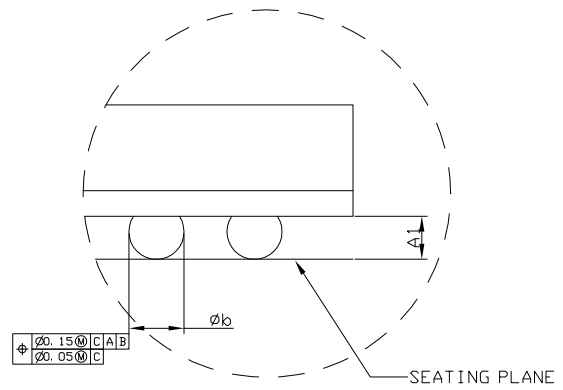

DETAIL "A"
ROTATED 90°

DIMENSION	MINIMUM	NORMAL	MAXIMUM
A	-	1.36	1.45
A1	0.35	0.40	0.45
A2	0.92	0.96	1.00
b	0.45	0.50	0.55
BALL COUNT : 144			

- NOTES:
1. ALL DIMENSIONS AND TOLERANCE CONFORM TO ASME Y14.5M-1994.
 2. PIN 1 IDENTIFIER CAN BE CHAMFER, INK MARK, METALLIZED MARK OR SHINY DOT, MUST BE BUT LOCATED WITHIN ZONE INDICATED.
 3. DIMENSION "b" IS MEASURED AT THE MAXIMUM SOLDER BALL DIAMETER PARALLEL TO PRIMARY DATUM C.
 4. COMPLIANT TO JEDEC REGISTERED OUTLINE MO-XXX.
 5. RAW SOLDER BALL SIZE DURING ASSEMBLY IS $\phi 0.45\text{mm}$.

UNLESS OTHERWISE SPECIFIED
DIMENSIONS ARE IN MIUMETERS.
TOLERANCES ARE:

DECIMALS	ANGLES
X. ± 0.1	± 1°
X.XX ± 0.05	
X.XXX ± 0.050	

			TITLE		18. 0X18.0mm, 420BALL, 0.80PITCH, 0.70CAP., 1.45THICKNESS		
			DES. BY	연규원/권혁만	14.03.17	DWG. NO	GPD0062
CHE. BY			REV. NO	UNIT	SCALE	SHEET	
DRA. BY			0	MM	1/1	1/1	
APP. BY	이사/이우섭	14.03.17					